

**Total thickness: 60**

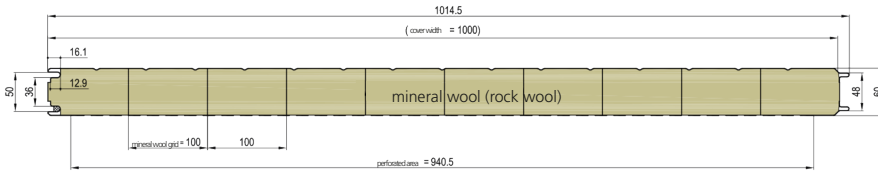

**Total thickness: 80**

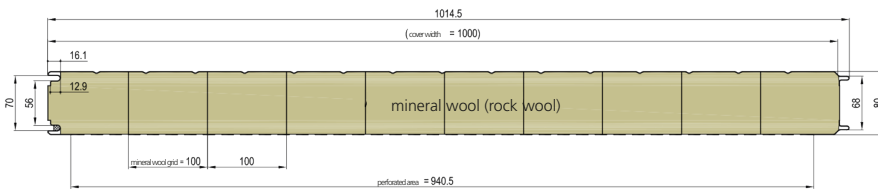

**Total thickness: 100**

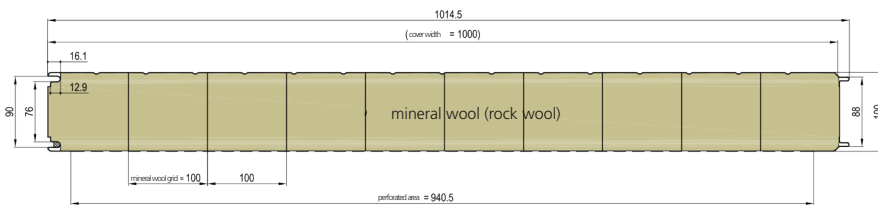

**Total thickness: 120**

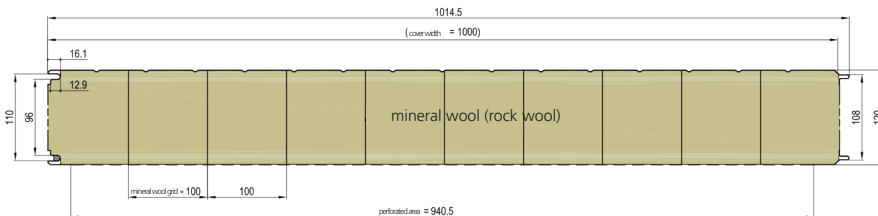

**Detail**

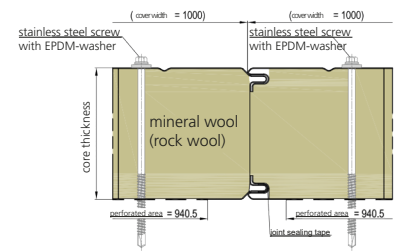

**Detail hole pattern**

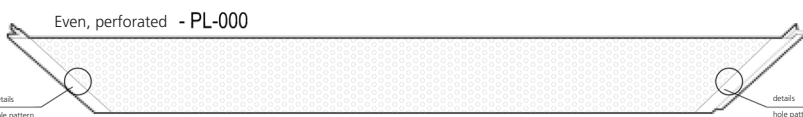
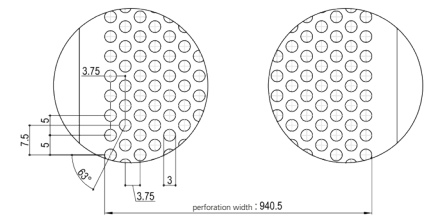

tolerances apply according to DIN EN 14509

All drawings are only to be used for construction and assembly. Other use needs to be checked with us in written form.		Metecco Baustysteme GmbH Am Amseiberg 1 51444 Burscheid	standard o.M.	position	amount
order reference	000177	date		drawing-no.	07-B-1
drawn up	03/17/14	check		Hipertec Wall-Sound	
approved	03/17/14	date in charge		Sandwich-wall panel with insulation core made of mineral wool (rock wool)	
				HTWS-MIWO	
change	date	name	Metecco Baustysteme GmbH		

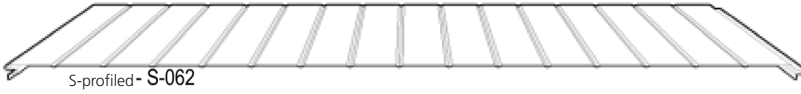

**Total thickness: 150**

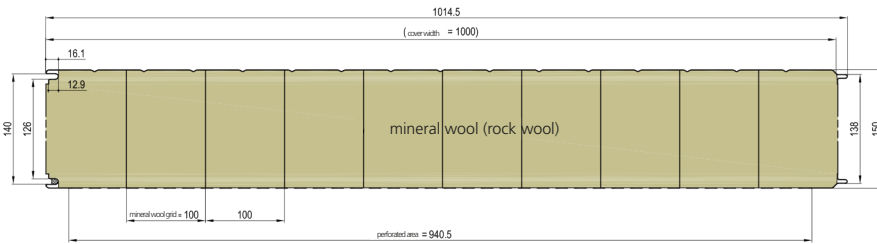

**Total thickness: 200**

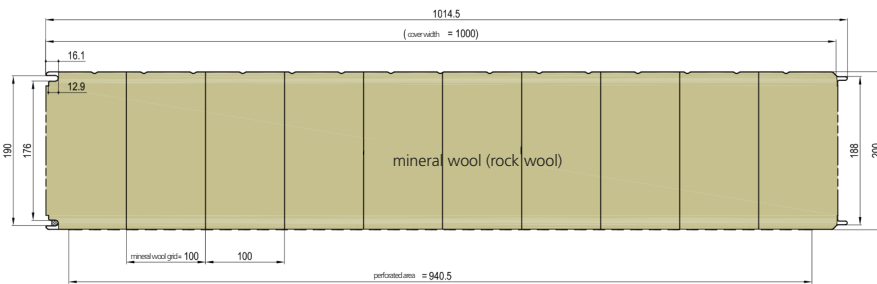

**Total thickness: 240**

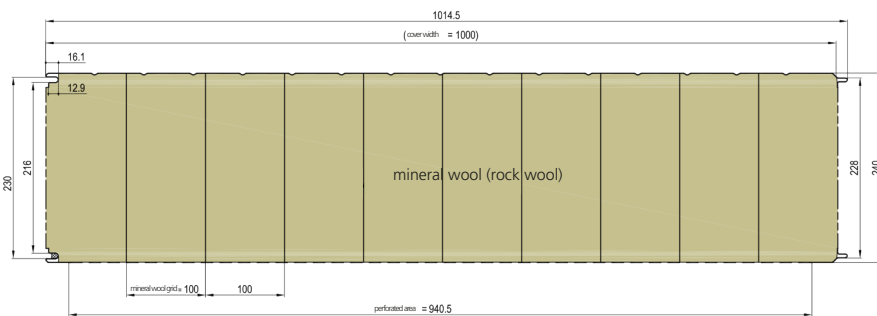

**Detail**

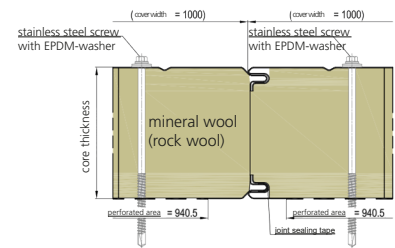

**Detail hole pattern**

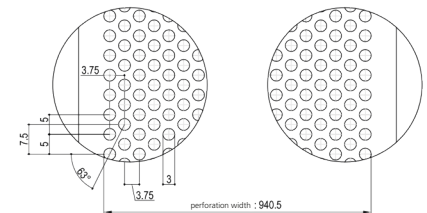

**Even, perforated - PL-000**

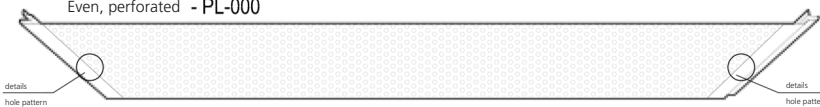

tolerances apply according to DIN EN 14509

All drawings are only to be used for construction and assembly. Other use needs to be checked with us in written form.		Metecno Bausysteme GmbH Am Amelsberg 1 59444 Birkenschan	standard o.M.	position	amount
01	stand. Metecno 2020m Sandwich-Wandplatten	000177	2/6 D2	date	name
	drawn up	03/19/14	ZB-Cramer		
	approved	03/19/14	Pr.-Graf		
	checked				
	draw in charge		U. Schulz		
		HTWS-MIWO			
author	change	date	name	Metecno Bausysteme GmbH	

drawing-no. 07-B-2

Hipertec Wall-Sound  
Sandwich-wall panel with insulation core  
made of mineral wool (rock wool)