

Wall panel type Monowall

Vertical installation

Fixing/fasteners

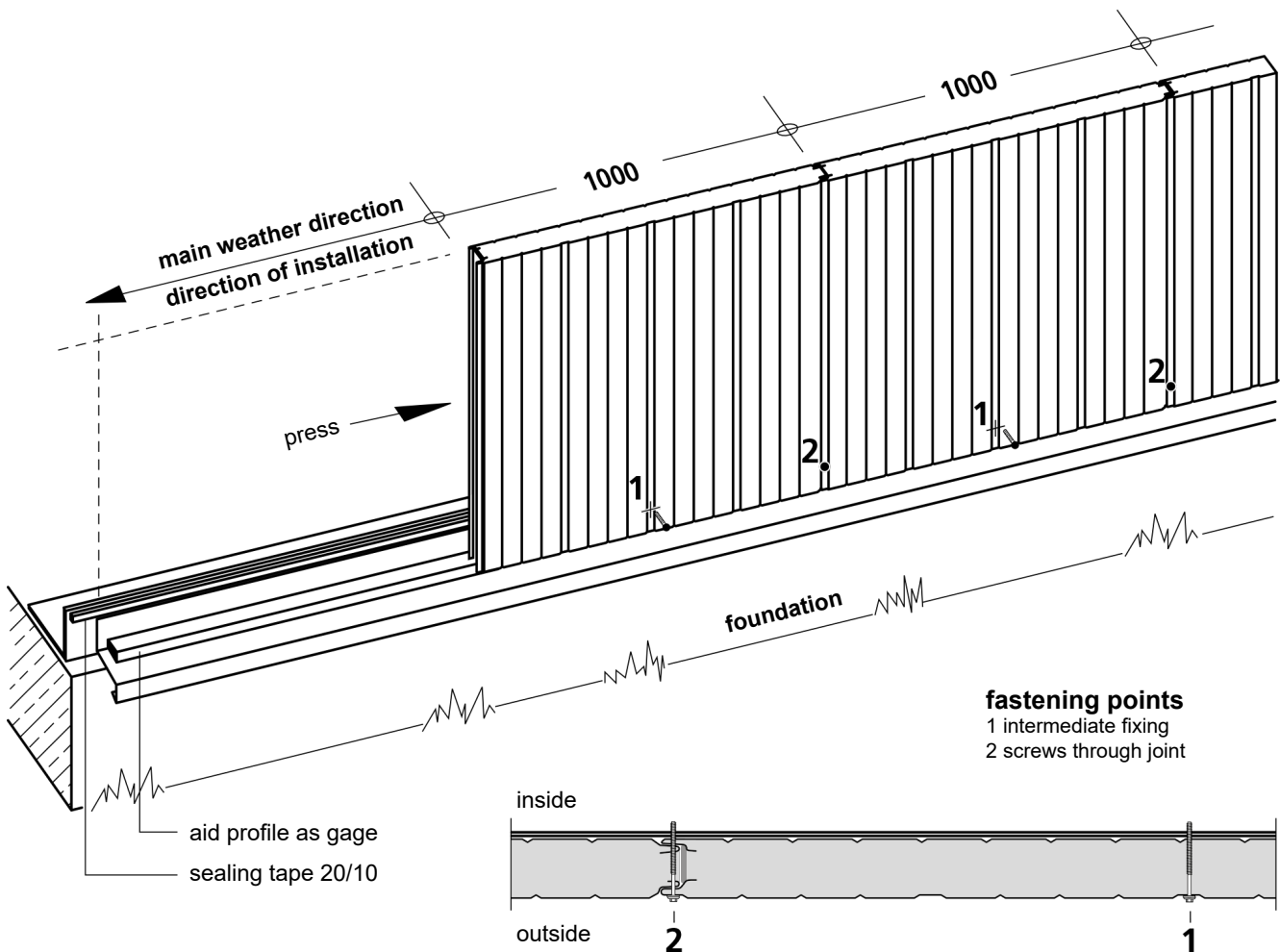

Fixing

The number of fasteners necessary is determined by the statics, the approval Z-14.4-407 for fasteners and the guidelines of DIN 1055 (wind suction load).

A static engineer must determine how many screws are needed for the surface, the corners and edge areas.

The panels must be fixed constructively with two screws at the end support or the intermediate support respectively. The fixing of the longitudinal joint is not necessary.

Fasteners

Only approved stainless steel screws (material 1.4301) with EPDM-washers are to be used for the fixing. Here, you can choose between thread-forming and self-drilling screws.

The following table shows the measurements of thread-forming screws for different panel thicknesses.

Insulation thickness (mm)	Steel support Ø 6,3 mm	Wooden support* Ø 6,5 mm
40	≥ 60	≥ 100
50	≥ 70	≥ 110
60	≥ 80	≥ 120
70	≥ 90	≥ 130
80	≥ 100	≥ 140
100	≥ 120	≥ 160
120	≥ 140	≥ 180

The necessary lengths of screws differ between suppliers. When using thread-forming screws, please have a look at the prescribed hole diameter of the screw supplier depending on the thickness of the steel subconstruction.

*) According to DIN 1052, when having a wooden subconstruction, pilot drilling is mandatory. Hole diameter = 0,7 x screw diameter.

The thickness of the steel subconstruction must at least be $t \geq 1,5$ mm while the hole depth in coniferous wood must be at least 50 mm. For further information and minimal steel thicknesses for certain screw types, have a look at the approval for screws Z-14.4-407 of the IFBS and at the details given by the screw suppliers.